



RIDGEWAY

COMBISAFE

SITE STAIRWAY LOCK

Prod.no. 11005

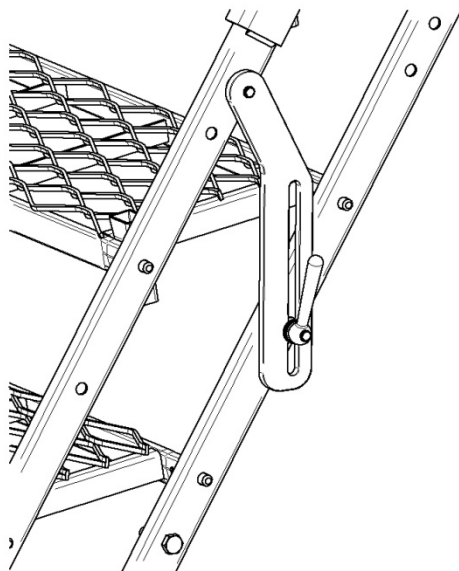

USER INSTRUCTIONS

General info

The Combisafe Site Stairway Lock is designed to fit all Site Stairways. The lock is manual and locked/released by a clamping lever. The design features a slotted plate which allows stepless adjustment in the range of 0-50° inclination independent of outer conditions.

Only one lock per stair is necessary and the design allows the lock to be positioned on either right or left hand side. The lock can be mounted on folded as well as already erected stairs.

© Combisafe International AB – UI 11005-EN-1107

Technical data

Combisafe Site Stairway Lock 11005

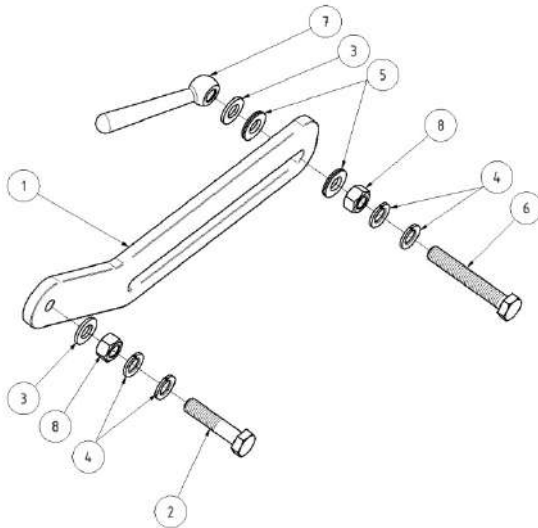

Figure 1. Content, Combisafe Site Stairway Lock.

Pos.	Quantity	Prod. No.	Description
1	1	11006	Locking plate
2	1	100138	Hexagon head bolt, ISO 4014-M10x45
3	2	100373	Plain washer, ISO 7089-10,5x20x2
4	4	100375	Split spring washer, DIN 128-A10-10,2x18x1,8
5	2	100376	Lock washer, NL10 sp-10,7x21x2,5
6	2	100377	Hexagon head screw, ISO 4017-M10x65
7	1	100378	Clamping lever, DIN 99 N80-M10
8	2	100374	Hexagon nut, ISO 4034-M10

Dimensions and weight

[mm]

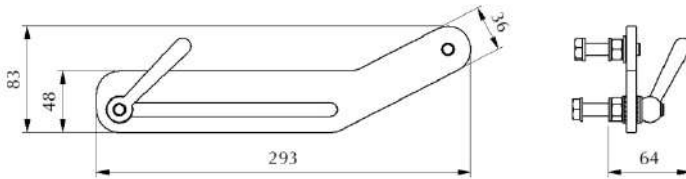

Figure 2. Overall dimensions.

Prod.No	Description	Weight
11005	Combisafe Site Stairway Lock	0,9 kg

Assembly

The lock can be placed on either side of the stair, this user instruction is showing a right hand assembly on a folded stair. The side rails are equipped with pre-cut holes in the lower part of the stair for mounting the lock.

1. Mount the upper M10x45 screw on the stair with washers and nut. Find the right components with help from the numbered balloons in figure 3 and compare them to figure 1. It is important that the screws are positioned in the correct holes due to their different length. Note that the shorter screw shall be placed in the upper side rail. Put one split-ring washer (POS 4) on both sides of the side rail.

Mount the nut (POS 8) on the outside of the stair. Tighten until the lock washers are fully compressed, but not so hard that the side rail is deformed.

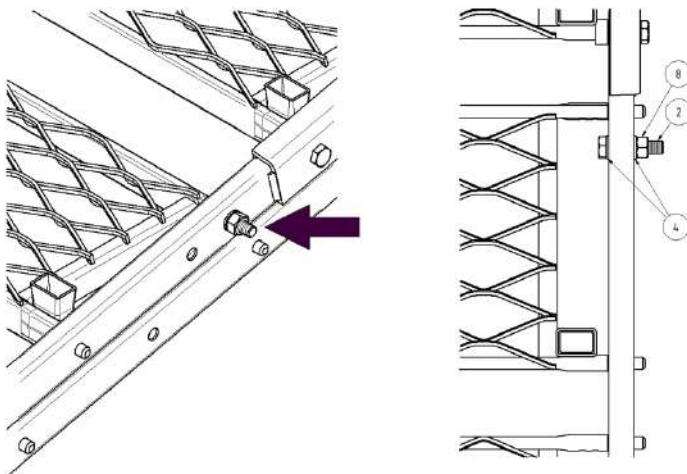

Figure 3. Mounted screw.

- Put the spacer washer (POS 3) onto the screw.

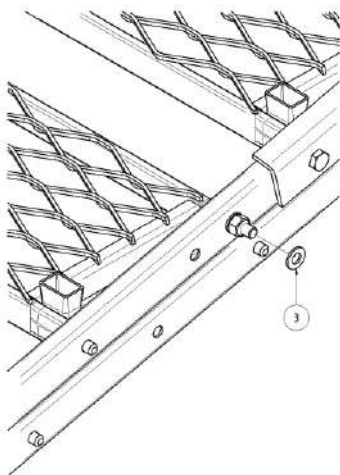

Figure 4. Mounted washer.

- Mount the lower M10x65 screw on the lower side rail of the stair with washers and nut. Find the right components with help from the numbered balloons in figure 5 and compare them to figure 1. Put one split-ring washer (POS 4) on both sides of the side rail.

Mount the nut (POS 8) on the outside of the stair.

NOTE ! Do not tighten the nut fully yet, only so that the screw end is flush with the nut (See right picture in figure 5).

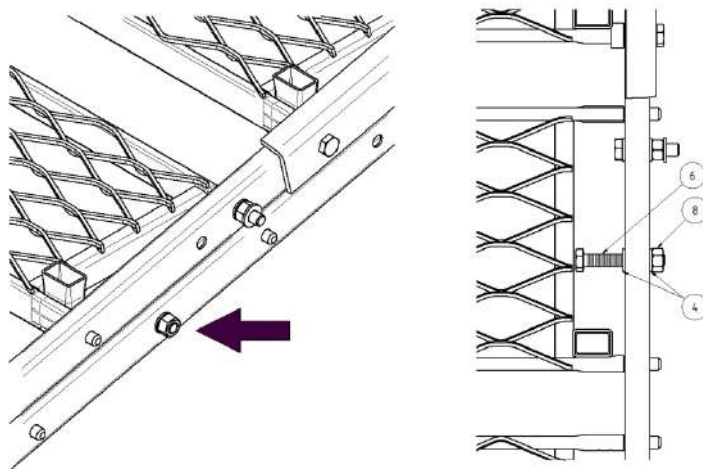

Figure 5. Lower screw is attached to side rail.

4. Mount the locking plate (POS 1) on the upper screw by using its threaded hole. Rotate the locking plate clockwise. Make sure the lock does not bind - it must be able to pivot freely on the screw.

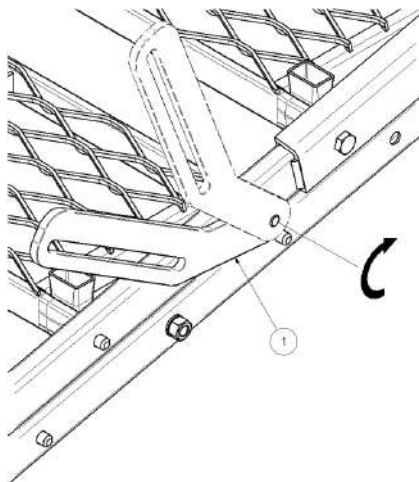

Figure 6. Locking plate is mounted on top screw.

5. Use a lock washer (POS 5) on the inside of the lock and tighten the lower screw fully while the screw is protruding the oblong hole in the lock plate. Tighten until the lock washers (POS 4) are fully compressed, but not so hard that the side rail is deformed. Then place another lock washer (POS 5) on the outer side of the lock, a plain washer (POS 3) and finally the clamping lever (POS 7).

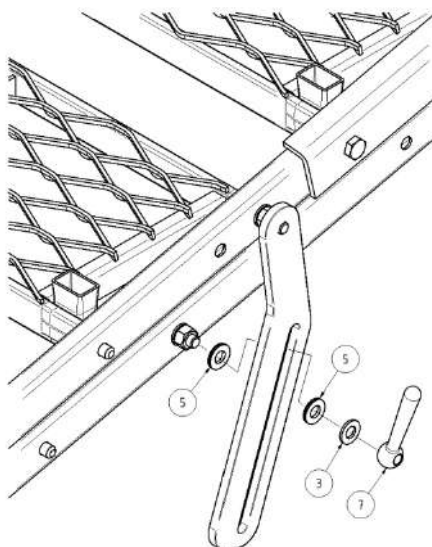

Figure 7. Clamping lever is mounted.

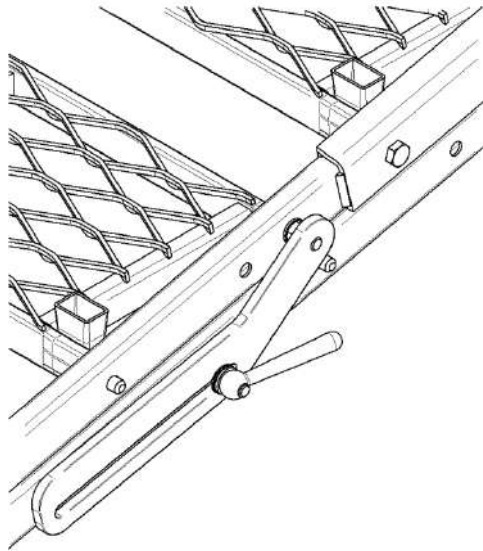

Figure 8. Finalized assembly.

Inspection

Regularly make sure the clamping lever is properly tightened and check the function by pulling /pressing on the handrails.

Safety Checks

Checking with fitted Site Stairway Lock

- Are the bolts/nuts tightened properly?
- Can the lock move freely between its end positions with released clamping lever ?
- No damage to the screws, lock plate or clamping lever ?
- Check that the lock is free from dirt, concrete etc.

Disposal

Site Stairway Locks that no longer pass inspection can be recycled as steel.



Belfast: 103 Airport Road West, Belfast, Co. Down, BT3 9ED Tel: +44 (0) 28 90454599

Ashbourne: Unit 1 & 2 Greene Park, Ratoath Road, Ashbourne, Co. Meath A84 XD98 Tel: +353 (01) 802 7173

Email: info@ridgeway-online.com Web: www.ridgeway-online.com